



# Application for New or Renewal of Off-Licence

(Including Club Off-Licence Renewals)

Sections 100 and 127(2), Sale and Supply of Alcohol Act 2012

Fill this form out with the assistance of the guide attached

☐ New Off-Licence ☒ Renewal Off-Licence

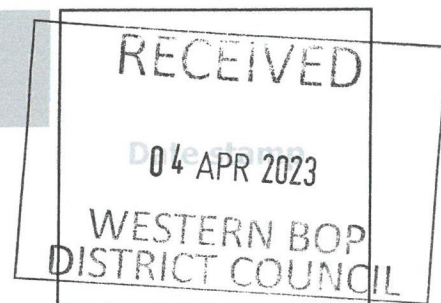

## 1. Applicant Details

a. ☒ Applicant/Property Owner ☐ Agent ☐ Other (provide contact details below)

b. Full name of applicant (legal entity who will receive the proceeds from the sale of liquor)

BVSS 2015 WINES & SPIRITS LIMITED

Previous names or other names known by WAIHI BEACH LIQUOR CENTRE

Postal address 18A Wilson Road, Waihi Beach

Occupation Owner

Date of Birth

Phone: Business (.....) Private (.....) Mobile (027) 2051170

Email gurwindsingh614@yahoo.com

Fax

Website address

c. Preferred means for formal correspondence

☐

Mail

☒

Email

☐

Fax

d. Status of applicant

☐ Natural Person

☐ Local Authority

☐ Body Corporate to which Section 28(1)(b)(f) of the Act applies

☒ Private Company

☐ Trustee

☐ Manager under the Protection of Personal Property Rights Act 1988

☐ Partnership

☐ Public Company

☐ Government Department or other instrument of the Crown

☐ Club

☐ Licensing Trust

☐ Board, organisation, or other body to which section 28(1)(c)(f) of the Act applies

e. Does the premises hold an existing licence?

☒ Yes ☐ No

f. Is there an existing licence held for the premises or conveyance concerned?

☐ Yes ☐ No

State type of licence OFF LICENCE

Number 022/ RENOFF/7870/2020

**Deposit Fee: \$350.00**

**Note:** This is a deposit only. An invoice for the outstanding balance will be sent to the applicant once the correct weighting category has been selected. The outstanding balance is required to be paid prior to the licence being issued.

(for office use)	RECEIVED	
	04 APR 2023	
Date received (date stamp)	WESTERN BOP DISTRICT COUNCIL	LIQL
	Application 8898	Premise No
	Receipt 2023/167348	Contact ID 171 536

## 1. Applicant Details *(Continued)*

g. Have your or any business partners been convicted of any offence?

☐ Yes

☐ No

If Yes, what are the details of each offence?

*(NOTE: You are entitled to protection under the Criminal Records (Clean Slate) Act. Disclose only convictions not eligible for concealment under the Clean Slate Act)*

Name	Nature of Offence	Date of Conviction	Penalty Suffered
.....	.....	...../...../.....	.....
.....	.....	...../...../.....	.....
.....	.....	...../...../.....	.....
.....	.....	...../...../.....	.....

*(NOTE: Continue on a separate page if necessary and attach to this application)*

h. Is this the applicant's first licensed premises?

☐ Yes

☐ No

If yes, has the applicant prepared a financial plan for the business?

☐ Yes

☐ No

## Select one of the following (Numbered 2 - 5):

### 2. Further Details Where Applicant is a Company

a. Date of Incorporation 04 / 02 / 2015

b. Place of Incorporation TAURANGA

c. Full details of each Director and the Secretary

Name	Address	Date of Birth	Place of Birth	Position Held
GURWINDER SINGH	.....	...../...../.....	INDIA	DIRECTOR
MANDEEP KAUR	.....	...../...../.....	INDIA	DIRECTOR
.....	.....	...../...../.....	.....	.....
.....	.....	...../...../.....	.....	.....
.....	.....	...../...../.....	.....	.....

### 3. Further Details where Applicant is a Private Company

a. ☐ Authorised capital ☐ Paid-up capital

b. Full details of each person who holds any shares issued by the company

Name	Address	Date of Birth	Place of Birth	Position Held	Face value of shares (eg 100 x \$1 shares)
.....	.....	...../...../.....	.....	.....	.....
.....	.....	...../...../.....	.....	.....	.....
.....	.....	...../...../.....	.....	.....	.....
.....	.....	...../...../.....	.....	.....	.....
.....	.....	...../...../.....	.....	.....	.....

#### 4. Further Details where Applicant is a Public Company

- a. Full details of each person who holds 20% or more of the shares, or any particular class of shares, issued by the company

Name	Address	Date of Birth	Place of Birth	Position Held
.....	.....	...../...../.....	.....	.....
.....	.....	...../...../.....	.....	.....
.....	.....	...../...../.....	.....	.....
.....	.....	...../...../.....	.....	.....
.....	.....	...../...../.....	.....	.....

#### 5. Further Details Where Applicant is a Partnership

- a. Full details of each partner as follows

Name	Address	Date of Birth	Place of Birth	Signature
.....	.....	...../...../.....	.....	.....
.....	.....	...../...../.....	.....	.....
.....	.....	...../...../.....	.....	.....
.....	.....	...../...../.....	.....	.....
.....	.....	...../...../.....	.....	.....

#### 6. Premises Details

- a. Existing trading name for premises WAIHI BEACH LIQUOR CENTRE  
Proposed trading name for premises WAIHI BEACH LIQUOR CENTRE  
Address of proposed licensed premises 18A Wilson Road, Waihi Beach
- b. Is a licence sought conditional upon construction or completion of building work? ☐ Yes ☒ No
- c. Do you own the proposed licensed premises? ☐ Yes ☒ No

##### If no:

- (i) Full name of the owner COLIN GILLARD  
• Full address of the owner .....
- (ii) What form of tenure of the premises will you have? 18A WILSON ROAD, WAIHI BEACH  
• What term of tenure will you have? UNTIL 2036
- d. Type of premises
- ☐ Hotel or Tavern    ☐ Supermarket    ☒ Premises on which principal business is manufacture or sale of liquor  
☐ Club    ☐ Grocery store    ☐ Internet based  
☐ Other, please state .....

#### 7. Designated Areas

- a.. What part (if any) as indicated on the attached floor plan, of the premises do you intend should be designated as
- (i) A restricted area .....
- (ii) A supervised area SUPERVISED AREA
- (iii) An undesignated area (*specify reason*) .....

## 8. Business Details

- a.. Is the sale of liquor intended to be the principal purpose of the business? ☒ Yes ☐ No

**If no:**

- (i) What is intended to be the principal purpose of the business? .....

- (ii) What part of section 32 of the Sale of and Supply of Alcohol Act is applicable to this application? (*Refer to copy of section 32 attached*).  
.....

- b.. Are you engaged, or intending to be engaged, in the sale or supply of any goods other than liquor or food, or in the provision of any services other than those directly related to the sale or supply of liquor and food? ☒ Yes ☐ No

**If yes,** what is the nature of those other goods and services? SMOKES & TOBACCO, SOFT DRINKS, CHIPS, CHEW GUN, BEEF JERKY ETC  
.....  
.....

- c.. What days and hours do you intend to sell liquor under the licence? (*The days and hours should reflect the entire hours you intend to operate your business and should be no greater than what was applied for on your Certificate of Compliance*)

**Days** MONDAY TO SUNDAY **Hours** From 8.00AM To 9.00PM  
.....  
.....

- d.. Do you intend to provide complimentary samples of liquor on the premises? ☒ Yes ☐ No

## 9. Conditions

- a. What experience and training has the applicant undertaken:

LCQ QUALIFICATION & GENERAL MANAGER CERTIFICATION  
.....

RUNNING LIQUOR STORE SINCE 2009 FRASER COVE LIQUOR CENTRE  
.....  
.....

- b. What steps do you propose to take to ensure that the requirements of the Act in relation to the sale of liquor to prohibited persons are observed?

PROHIBITED PERSONS INCLUDES MINORS AND INTOXICATED CUSTOMERS YOU CANNOT SERVE INTOXICATED PEOPLE OR ALLOW THEM TO REMANIN IN THE PREMISES. CHECKING IDENTIFICATION OF YOUR CUSTOMERS LIKE 18+ CARDS, NZ DRIVERS LICENCE, NZ AND OVERSEAS PASSPORTS.  
.....  
.....

- c. What other steps does the applicant propose to promote the responsible consumption of alcohol?

UNDER THE NEW ACT IT IS AN OFFENCE TO ENCOURAGE EXCESSIVE CONSUMPTION OF ALCOHOL, PROMOTE ALCOHOL FOR FREE AND PROMOTE ALCOHOL IN A WAY THAT HAS A SPECIAL APPEALS TO MINORS  
.....  
.....

- d. What other systems (including training systems), and staff in place (or to be in place) for compliance with the Act?

STAFF WILL NEED TO BE TRAINED SO THRY CAN IDENTIFY INTOXICATED CUSTOMERS, ENSURE THE CORRECT IDENTIFICATION IS PROVIDED. STAFF WILL BE USING THE SCAB TOOL TOO IDENTIFY INTOXICATED CUSTOMERS.  
.....  
.....

## 9. Conditions *(Continued)*

e. Are any changes sought to the present conditions of the licence (ie days or hours)?

- **IF NO** – Go straight to Section 11

☐ Yes ☒ No

- **IF YES** – Continue

Changes relating to the days and hours of the liquor licence

(i) What are the days and hours shown on the licence at present?

(ii) What are the changes sought?

Days

Hours

Days

Hours

.....

.....

.....

.....

.....

.....

.....

.....

.....

.....

.....

.....

f. Changes relating to other conditions of the liquor licence

(i) What are the conditions of the licence at present?

(ii) What are the changes sought?

.....

.....

.....

.....

.....

.....

What are the full reasons for the changes sought? .....

.....

Where **changes to the days and/or hours** of the licence are sought, has the applicant:

- Contacted the Western Bay Duty Planner Consents on 571 8008 prior to submitting this application to obtain advice as to whether the changes comply with planning requirements and or any resource consents relevant to the premises?

☐ Yes ☐ No

- Filed for a Certificate of Compliance with the renewal application? The Certificate of Compliance provides the required official confirmation the changes comply with all planning requirements

☐ Yes ☐ No

## 10. Management of Premise

At all times when liquor is being sold or supplied to the public, a manager (appointed under Section 217 of the Sale and Supply of Alcohol Act) must be on duty (except where section 215 of the Act applies to Club's).

a. Details of **ALL** managers currently employed:

- Full name GURWINDER SINGH

- Certificate number 21/CERT/27348/2022

- Residential address [REDACTED]

- Expiry date 05 / 11 / 2025

- Full name HARMOLVIR SINGH

- Certificate number 21/CERT/25843/2020

- Residential address [REDACTED]

- Expiry date 24 / 10 / 2023

- Full name .....

- Certificate number .....

- Residential address .....

- Expiry date .....

(Continue on separate sheet if necessary)

- b. If no managers have yet been appointed, what is your proposal relating to Section 214 of the Sale and Supply of Alcohol Act requiring a manager to be present at all times?

## 11. Further details where the licence is a club licence

It is a requirement to have in place a written host responsibility policy outlining the establishment's commitment to providing a safe drinking environment. This policy should be prominently displayed in the premises. Examples of draft host responsibility policies are provided at the back of the attached Pacific Health questionnaire for your reference. If you have any questions concerning this, please contact Pacific Health on 571 8975.

Copy of the host responsibility policy is attached

☐ Yes ☐ No

## 12. Signature of Applicant

- a. Before signing the application, please refer to and complete the check list at the end of this form.

b. Applicant's signature .....  ..... Date 04/04/2023  
(must be signed by the Licensee personally)

- Please note – If applying as a company, please indicate your relationship to the company, eg Director, Secretary

Relationship DIRECTOR .....

Name GURWINDER SINGH .....

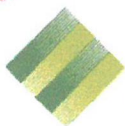
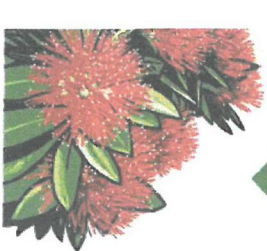

Western Bay of Plenty  
District Council

Head Office Barks Corner, 1484 Cameron Rd, Greerton, Tauranga  
Private Bag 12803, Tauranga Mail Centre, Tauranga 3143  
Ph 07 571 8008 (24 hours) • F 07 577 9820  
Freephone 0800 WBOPDC • 0800 926 732  
E customerservice@westernbay.govt.nz  
www.westernbay.govt.nz

## New Zealand Fire Service Data Sheet (all applications)

### Section 76 of the Fire and Emergency New Zealand Act 2017

In accordance with s.100 and s.127 of the Sale and Supply of Alcohol Act 2012, an application for an On, Off, or Club Licence, respectively, must be accompanied by a statement regarding the need for, or provision of, an Evacuation Scheme as required by section 76 of the Fire and Emergency New Zealand Act 2017

*If you have any questions regarding an Evacuation Scheme for your premises please contact Luke Burgess (Fire Risk Manager, NZ Fire Service) at [luke.burgess@fireandemergency.nz](mailto:luke.burgess@fireandemergency.nz) or Jon Rewi (Te Puke area) at [jon.rewi@fireandemergency.nz](mailto:jon.rewi@fireandemergency.nz)*

### Please complete and then tick which statement applies:

The building, located at:

18A WILSON ROAD, WAIHI BEACH

.....(address)

in which the premises known as

WAIHI BEACH LIQUOR CENTRE

.....(name of premises)

☒ has a current Fire Evacuation Scheme.

☐ does not require (by reason of its current use) an Evacuation Scheme.

☐ is exempt from having to meet the requirements for an Evacuation Scheme.

Signed:  Date: 04/04/2023

Name: Gurwinder Singh

*Please note, section 286 of the Sale and Supply of Alcohol Act 2012 outlines the provision for suspension of a licence for non-compliance with public health or fire precaution requirements.*

A2622843



## Sale and Supply of Alcohol Act 2012 Public Health Questionnaire for Off-Licence Applications

This questionnaire helps ensure that licensees meet the requirements of the Sale and Supply of Alcohol Act 2012 in relation to the public health consequences of alcohol use, such as alcohol-related health problems and preventable death or disability from alcohol-related motor vehicle crashes.

This questionnaire will enable the completion of the Medical Officer of Health report on your license application. Your license application cannot be processed without completion of this questionnaire.

Name of Licensed Premises: WAIHI BEACH LIQUOR CENTRE

Name of applicant: Gurwinder Singh

Type of application:	New <input type="checkbox"/>	Renewal <input type="checkbox"/>	
Premises type:	Bottle store <input checked="" type="checkbox"/>	Supermarket <input type="checkbox"/>	
	Tavern <input type="checkbox"/>	Grocery <input type="checkbox"/>	
	Online <input type="checkbox"/>	Auctioneer <input type="checkbox"/>	

Other .....

### Social Responsibility

- a. Do you have a written policy outlining how you will meet your responsibilities under the Act? Yes ☒ No ☐  
 If yes, please attach a copy.
- b. Do you have tastings? Yes ☒ No ☐  
 If yes, is water freely available? Yes ☒ No ☐

### Amenities and Good Order

What steps will you take to ensure your business does not impact negatively on your neighbours? eg noise, nuisance and vandalism?

.....

.....

### Staff Training

- a. Do you provide training to staff on the SaSA 2012? Yes ☒ No ☐

If yes: In-house training, by whom?

By the store Manager

Courses, provided by? .....

### Intoxicated Patrons

- a. How do you prevent intoxicated people from entering your premises?

WE WILL STOP HIM AT THE ENTRANCE OF PREMISES  
.....

- b. How do you identify if a person is intoxicated?

WE CHECK THE SIGNS OF INOXICATION. 1. BALANCE, 2. BREATH, 3. RED EYES  
4. COMMUNICATION  
.....

- c. What process do you have to deal with intoxicated patrons?

WE WILL KINDLY ASK THEM TO NOT ENTER THE PREMISES AND IF NEEDED WE WILL  
ARRANGE A TAXI FOR THEM, ALSO OFFER THEM WATER.  
.....

- d. Do you display signage stating that intoxicated patrons will not be served alcohol? Yes ☒ No ☐  
(This signage can be provided by the Public Health Service)

### Minors

- a. What forms of identification do your staff accept?

NZ photographic driver's license Yes ☒ No ☐

NZ or overseas passports Yes ☒ No ☐

HANZ 18+ card Yes ☒ No ☐

Other forms of I.D – *please describe*  
.....

- b. Do you display signage stating alcohol will not be sold to minors? Yes ☒ No ☐

- c. Are staff aware of their responsibilities under the Sale and Supply of Alcohol Act regarding supply of alcohol to minors? Yes ☒ No ☐

- d. What process do you have in place to prevent minors from entering your premises?  
WE ASK FOR IDENTIFICATION AT THE ENTRANCES  
.....

- e. Do you have on-line sales? Yes ☐ No ☒

If yes, what steps do you take to ensure alcohol is not sold to minors?  
.....

### Alcohol Promotion

Do you run alcohol promotions (e.g. free products/services, competitions, 2 for 1 deals, etc) Yes ☒  
No ☐

Give recent examples

ONLY THE FINANCHISE PROMOTIONS  
.....

Do you have exterior advertising?

Yes ☒ No ☐

Building ads,

Yes ☒ No ☐

Sandwich boards,

Yes ☒ No ☐

Billboards

Yes ☒ No ☐

What percentage of your front window is covered in alcohol advertising?

0% .....

What alcohol brands and products are you currently advertising in your windows? Give examples.

FINANCHISE PROMOTIONS .....

### FOR SUPERMARKETS AND GROCERY STORES ONLY

In which area of the store is your alcohol located?

.....  
Please attach a floor plan.

Are your in-store alcohol promotions confined to the designated alcohol area? Yes ☐ No ☐

Please identify the categories of products your store sells (tick all appropriate actions)

Fresh meat (not including processed and cured meats eg bacon, salami, ham sausages etc)

Fresh produce (fruit, vegetables)

Frozen meat

Dairy products

Breads, cereals, rice, pasta

Staples – flour, spices, sugar and other items used for baking

Health and beauty

Tinned foods

Household – non grocery items that are needed for household maintenance – detergent, rubbish bags, cleaning supplies, etc.

Approximately what percentage of your store do the above products occupy?

### Smoke-free Environments Act 1990

Do you sell tobacco?

Yes ☒ No ☐

Are tobacco products visible to the public?

Yes ☐ No ☒

BVSS 2015 WINES & SPIRITS LIMITED

..... (Full name), the Licensee\* for

I have read and understood each of the above questions and I agree to comply with the measures outlined here throughout this next licensing period.

Signed:  .....

Dated: 04/04/2023 .....

Position/Title: DIRECTOR .....

*A Public Health Alcohol Regulatory Officer, on behalf of the Medical Officer of Health, may visit your premises, from time to time, in order to undertake a Sale and Supply of Alcohol Act 2012 compliance visit.*

**All applications filed after 18 June 2013 require the Agency to take into account the criteria of the Sale and Supply of Alcohol Act 2012 (section 105).**

**To support your application, please supply the information required and answer the questions listed in this form.**

### Scale Floor Plan

Provide a scale floor plan which also shows the design and layout of the premises.

This should include: (identifying your principal entrance)

- Seating and tables
- A list of facilities, ie bar, toilets, stage, etc.
- CCTV placement
- Security lighting

Also, for Off-Licences:

- A description of your product types, where they are displayed and stored.

### 1. The reporting agencies must consider any effects the issue of the licence will have on amenity and good order - please answer the following:

**For all licences:**

a) Advise proximity of all childcare centres, schools and churches within 500m - a site plan would assist.  
WAIHI BEACH CHURCH

b) How many residential neighbours would you have within 50 metres?  
ZERO

c) Security - what security systems do you have and state location (outdoor lighting, indoor/outdoor CCTV, other)?  
WE HAVE CCTV SYSTEM THAT COVERS OUTSIDE AND INSIDE. WE HAVE LED LIGHTING INSIDE AND OUTSIDE.

d) Internal layout - can the entire premises be seen by the cashier? Is there good visibility in the cool store areas (Off-Licence)? Where there are blind spots, are mirrors or CCTV installed? Is the internal lighting inside the premises suitable?  
YES

e) Windows - is there good visibility into and from the premises and the street?  
YES

f) Lighting - does the lighting outside the premises discourage loitering? Does the lighting allow staff to check ID's, etc?  
YES

g) Security - will you employ security staff and when will they be used?  
NO, I HAVE BEEN RUNNING THE STORE FOR ALMOST 6 YEARS AND HAD NO PROBLEMS

h) Security staff - how many security staff hold a Certificate of Approval and formal registration or qualification? If so wh

**Additional Information required for On-Licence and Club Licences.****Noise**

- i) Explain clearly all types\* of entertainment you will be providing and when (\* amplified music or large crowd noise relate)  
NOTHING
- j) Noise management - do you have a noise management plan or an acoustic report prepared by a suitably qualified and experienced Acoustic Engineer?  
NO
- k) Noise mitigation - what mitigation will/is be/being undertaken (include any details regarding noise monitoring)?  
\_\_\_\_\_

**What outside / off premise advertising involving liquor will you be doing?**

- l) Newspaper/Magazine  
NO
- m) Shop windows?  
THE BRANDING OF THE STORE
- n) On your premises - roof/other?  
THE BRANDING OF THE STORE
- o) Street/Footpath signs?  
STREET FOOT SIGN
- p) Social Media Sites i.e. Twitter/Facebook, Online Magazines, Websites, etc?  
RESPONSIBILITY ADVERTISING ON FACEBOOK

A copy or sample of your advertising would be of assistance

**Systems and Staff Training**

- q) Are you involved in any mystery shopper type programmes?  
NO
- r) What till prompt systems do you have regarding age checks?  
WHEN EVER WE SCAN SOMETHING IT COMES UP ON THE COMPUTER TO CHECK ID.
- s) What staff training is provided with regard to Sale of Alcohol compliance and Host Responsibility practices - explain content, duration and how often this training is provided.  
THIS IS PROVIDED BY STORE MANAGER
- t) Please provide copies of any written material you supply to staff regarding staff training (attach to this form).

**2. Marketing and Promotions**

- a) What percentage of the front windows will be clear and transparent?  
80%
- b) What is the target market for the business?  
EVERYONE THAT IS OVER 18 YEARS OLD AND NOT INOXICATED.

c)	What is your policy regarding pricing and promotions? <u>NOT TO PROMOTED PRODUCTS THAT ATTRACTED MINORS AND NOT TO PROMOTE</u> <u>OVER 25% OF THE RETAIL PRICE.</u>
d)	Will there be single sales (Off-Licence)? <u>YES</u>
<b>Renewals Only</b>	
e) of?	Have you had any complaints from the neighbours (including confirmed noise complaints) that you are aware of? <u>NO</u>
f)	Has your business been subject to a Police controlled Purchase Operation (CPO)? If so, what were the results? <u>YES. WE SERVED A UNDERAGE DURING POLICE CONTROLLED PURCHASE</u> <u>OPERATION.</u>
g)	Have you or your business ever appeared before the Alcohol Regulatory and Licensing Authority? If so, for what reason?  
<b>3. The granting, or renewal, of this application will contribute to the Object of the Act by:</b>	
•	Steps taken to ensure the sale, supply and consumption of alcohol will be undertaken safely and responsibly: <u>WE HAVE TRAINED STAFF THAT WILL NOT SERVE INOXICATED CUSTOMER AND</u> <u>CHECK ID</u>
•	The harm caused by the excessive or inappropriate consumption of alcohol will be minimised by: <u>THE TRAINED STAFF WILL NOT SERVE CUSTOMERS THAT CAN CAUSE HARM.</u> <u>THEY WILL INFORM CUSTOMERS ABOUT THE LIQUOR BAN AROUND THE STORE.</u>
<b>Any other comments you wish to make to support your application being determined:</b>	

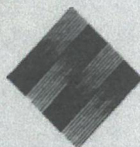

## Off Licence Renewal

*Sections 17 to 20, and 64, Sale and Supply of Alcohol Act 2012*

Pursuant to the Sale and Supply of Alcohol Act 2012 (the Act), **BVSS 2015 WINES & SPIRITS LTD** (the licensee) is authorised to sell alcohol on the premises situated at **18 WILSON ROAD, WAIHI, BEACH** and known as **WAIHI BEACH LIQUOR CENTRE**, to any person for consumption off the premises and to supply alcohol free, as a sample, for consumption on the premises. The licensee is also authorised to sell alcohol on or from the premises and deliver it somewhere else.

The authority conferred by this licence must be exercised through a manager or managers appointed by the licensee in accordance with Subpart 7 of Part 2 of the Act.

### CONDITIONS

This licence is subject to the following conditions:

1. Alcohol may be sold on, or delivered from, the premises for consumption off the premises, or supplied free as a sample for consumption on the premises only on the following days and hours:  
**Monday to Sunday 8.00 am to 10.00 pm.**
2. No alcohol is to be sold on, or delivered from, the premises on Good Friday, Easter Sunday or Christmas Day or before 1.00 pm on Anzac Day;
3. While alcohol is being supplied free as a sample, water is to be provided to patrons free of charge at the place where the samples are being supplied;
4. The whole of the premises is designated as a **Supervised Area**;
5. The licensee must have available for consumption on the premises, at all times when the premises are open for the sale and supply of alcohol, a reasonable range of non-alcoholic and low-alcohol beverages;
6. A properly appointed Certificated, or Acting or Temporary Manager must be on duty at all times, within the licensed area, when the premises are open for the sale and supply of alcohol and their full name must be on a sign prominently displayed in the premises.
7. The Licensee must display:
  - (a) At every point of sale, signs detailing restrictions on the sale and supply of alcohol to minors and intoxicated persons;
  - (b) At the principal entrance to the premises, so as to be easily read by people immediately outside the premises, a sign stating the ordinary hours of business during which the premises will be open for sale of alcohol;
  - (c) A copy of the licence attached to the inside of the premises so as to be easily read by people entering each principal entrance.

### DURATION

Subject to the requirements of the Act relating to the payment of fees, and to the provisions of the Act relating to the suspension and cancellation of licences, this licence continues in force—

- (a) until the close of the period for which it was last renewed; or
- (b) if an application for the renewal of the licence is duly made before the licence would otherwise expire, until the close of the period of 3 years after the period for which it was last renewed.

**This licence replaces licence no. 022/OFF/06/2016 and this licence continues in force until 12 May 2023 unless again renewed.**

Dated at Tauranga on the

day of August

The

Common  
Seal  
of

Secretary

District Licensing Committee  
Western Bay of Plenty District Council

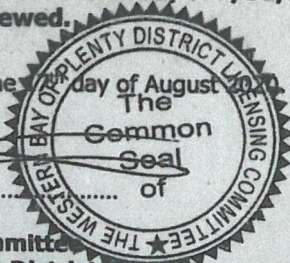

## CERTIFICATE OF COMPLIANCE WITH REQUIREMENTS OF RESOURCE MANAGEMENT ACT & BUILDING CODE

**Compliance Certificate Number: 241**

To the Western Bay of Plenty District Licensing Agency.

This letter serves as a certificate for the purposes of Section 100(F) of the Sale and Supply of Alcohol Act 2012.

This certificate refers to a proposal to conduct the following business on the premises.  
**(Here set out the general nature of the business to be conducted as set out in the application form).**

<b>APPLICANT:</b>	BVSS 2015 WINES & SPRITS LTD
<b>PREMISES:</b>	WAIHI BEACH LIQUOR CENTRE
<b>ADDRESS:</b>	18 WILSON ROAD, WAIHI BEACH
<b>NATURE OF BUSINESS:</b>	BOTTLE STORE
<b>DETAILS OF LICENCE:</b>	OFF LICENCE

The proposed use of the building meets the requirements of the Resource Management Act.

The building is an existing building that will not have a change of use and as such the building used for the proposed use meets the requirements of the New Zealand Building Code to the extent required by the Building Act 2004.

Signed for and on behalf of the Council

  
Signed

Environmental Consents Manager  
Designation

30 / 5 / 2016  
Date

# Waihi Beach Liquor Centre



Map indicating where the premises is located

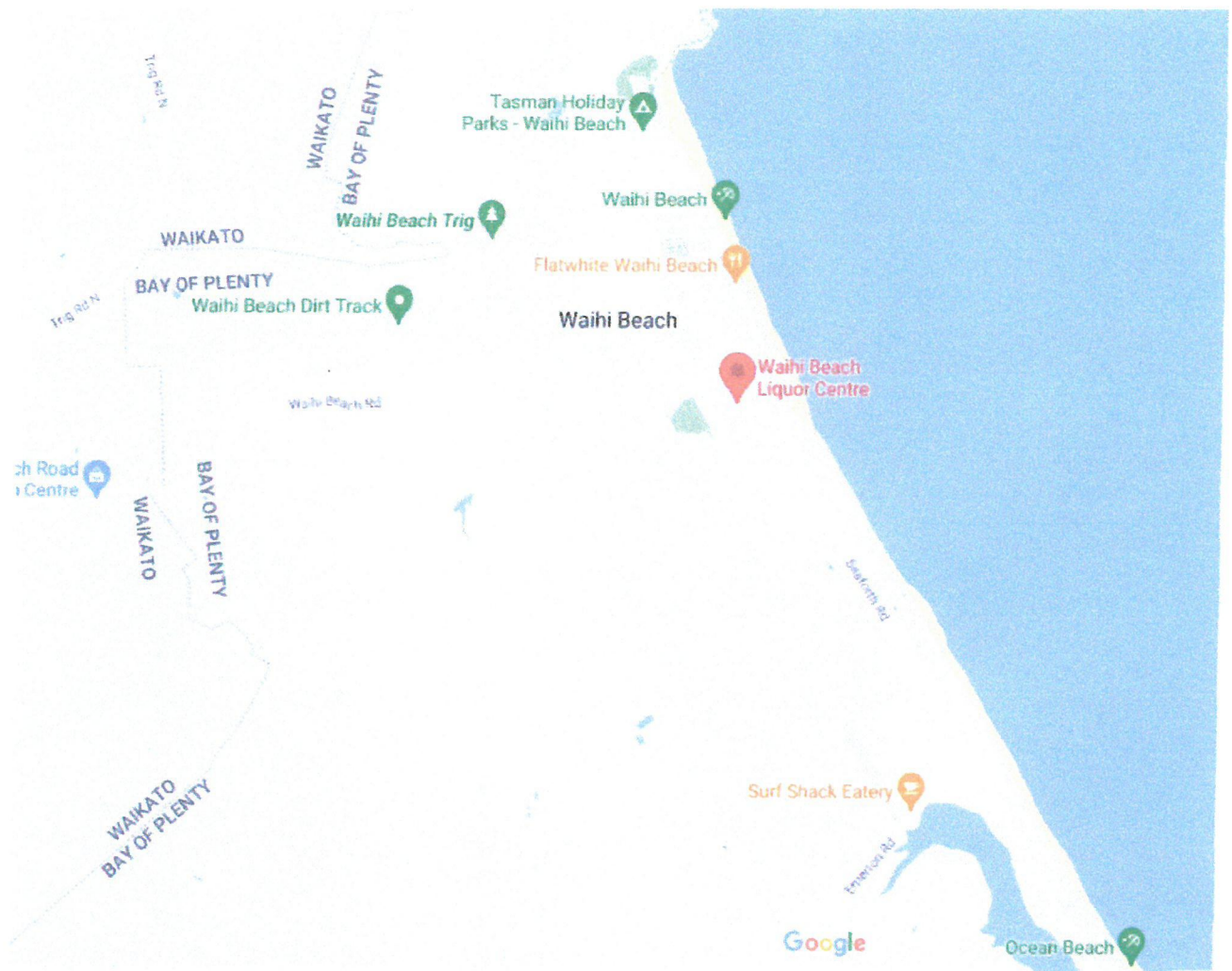

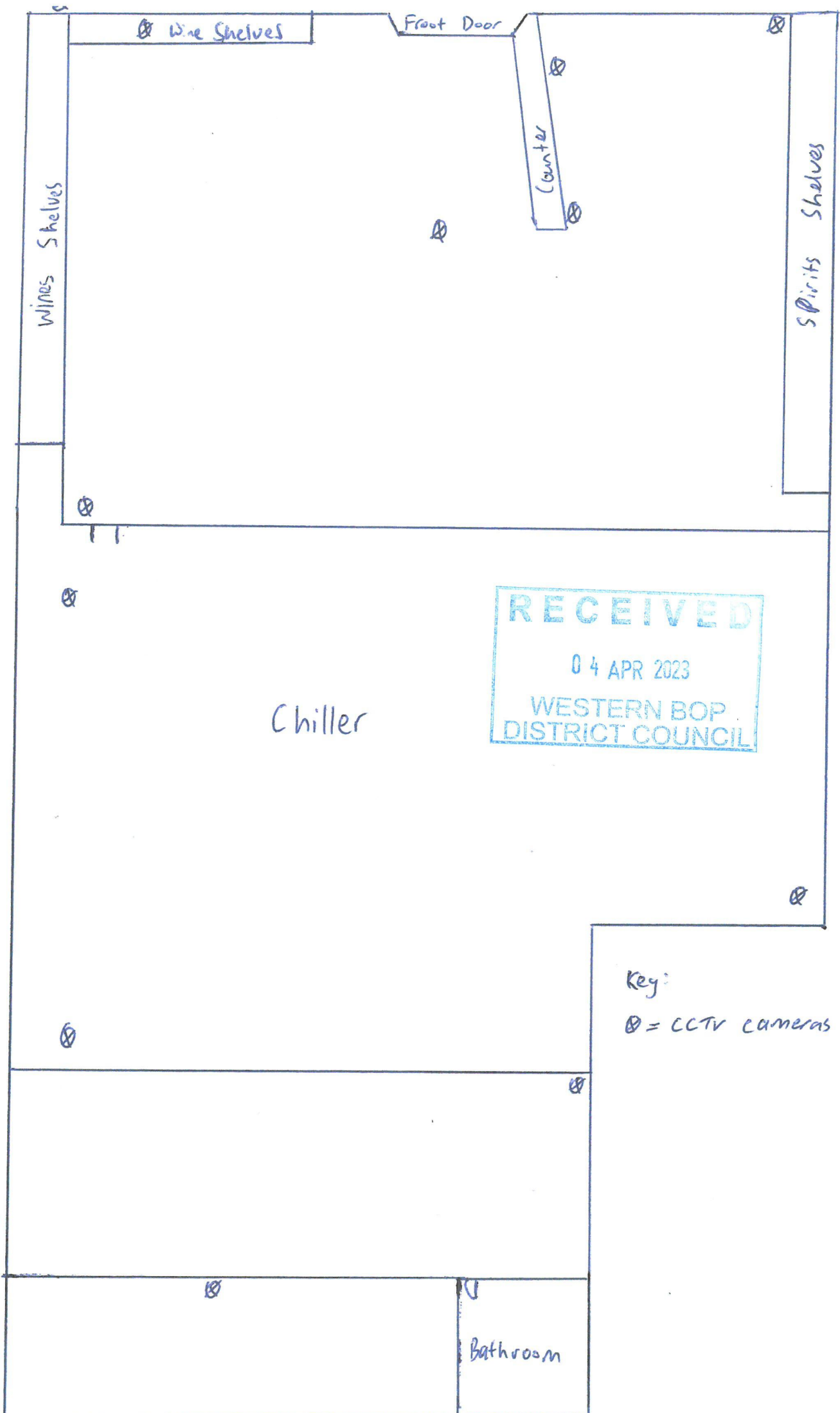

RECEIVED  
04 APR 2023  
WESTERN BOP  
DISTRICT COUNCIL

Key:

⊗ = CCTV cameras

## Sale and Supply of Alcohol Act 2012

### OFF LICENCE

#### “Waihi Beach Liquor Centre”

#### “Host Responsibility Policy”

- It is against the law to serve minors. If we are in doubt as to your age, we will ask for ID. Acceptable forms of proof of age are a current NZ photo driver's licence, HANZ 18+ card or a current NZ or Overseas Passport.
- NO ID NO SERVICE NO EXCEPTIONS
- We will not serve intoxicated persons.
- We operate within the requirements of the Sale of Supply of Alcohol Act 2012.
- Our Policy is to serve you in a friendly, responsible, and professional manner.

Thank You

Staff & Management

Waihi Beach Liquor Centre



# Tauranga District Licensing Committee

## SALE AND SUPPLY OF ALCOHOL ACT 2012

Certificate No. 21/CERT/25843/2020

### NOTICE OF RENEWAL OF MANAGER'S CERTIFICATE

Section 226, Sale and Supply of Alcohol Act 2012

## HARMOLVIR SINGH

Your manager's certificate is renewed.

Subject to the requirements of the Act relating to the payment of fees, and to the provisions of the Act relating to the suspension and cancellation of Manager's Certificates, this certificate.

**expires on 24 October 2023**

unless again renewed.

Renewed at Tauranga 03 December 2020

A handwritten signature in black ink, appearing to read "Te Oi Hamiora Rima KEMP".

Te Oi Hamiora Rima KEMP (Sam)  
**SECRETARY**  
**TAURANGA DISTRICT LICENSING COMMITTEE**



Certificate No. 21/CERT/27348/2022

### NOTICE OF RENEWAL OF MANAGER'S CERTIFICATE

Section 226, Sale and Supply of Alcohol Act 2012

## GURWINDER SINGH

Your manager's certificate is renewed.

Subject to the requirements of the Act relating to the payment of fees, and to the provisions of the Act relating to the suspension and cancellation of Manager's Certificates, this certificate.

**expires on 05 November 2025**

unless again renewed.

**Renewed at Tauranga** 27 January 2022

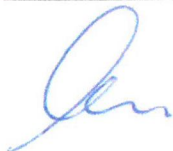

---

Nigel McGlone  
SECRETARY  
TAURANGA DISTRICT LICENSING COMMITTEE



## Re: Gurwinder Singh - Waihi Beach Liquor Centre

---

From: Colin Gillard (colandmarg@xtra.co.nz)

To: gurwindersingh614@yahoo.com

Date: Friday, March 31, 2023 at 02:08 PM GMT+13

---

Largo Holdings Prinsable Colin Gillard has no objection to this renewal , Kind Regards

On 30/03/2023, at 8:43 PM, Gurwinder Singh <[gurwindersingh614@yahoo.com](mailto:gurwindersingh614@yahoo.com)> wrote:

Hi Colin,

Our liquor license is up for renewal and the council needs a written statement from the landlord stating that you have no objection for this renewal to be granted?

So if you can please provide this, so we can submit our application for renewal of license.

Kind Regards  
Gurwinder Singh  
0272051170

## Certificate of Incorporation

**BVSS 2015 WINES AND SPIRITS LIMITED**

**5586965**

**NZBN: 9429041596302**

This is to certify that BVSS 2015 WINES AND SPIRITS LIMITED was incorporated under the Companies Act 1993 on the 4th day of February 2015.

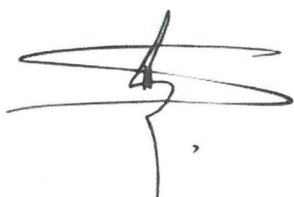

**Registrar of Companies**  
2nd day of April 2023

